

*Packages for Breakfast/ Lunch Meetings and  
Trainings*

*Time Frame 8:00am-4:00pm*

*Continental Breakfast/ Basic Sandwich Lunch*

*\$25.00 per person*

*Breakfast to include:*

*Assorted muffins, Danish, and pastries  
Orange, grapefruit, and tomato juices  
Coffee, regular and decaf, tea or soda*

*Lunch to include choice of the following:*

*Turkey Panini  
Burger  
BBQ Pork  
Your choice of chips, fries or fruit*

*Choice of dessert*

*Cheesecake or Godiva Cake*

*Continental Breakfast/ Corporate Lunch*

*\$30.00 per person*

*Breakfast to include:*

*Assorted muffins, Danish, and pastries  
Orange, Grapefruit, and Tomato juices  
Coffee, regular and decaf, tea or soda*

*Lunch to include three choices from the following:*

*Alsatian Chicken Salad*  
*Caesar Salad with Chicken or Salmon*  
*BBQ Pork Sandwich*  
*Grilled Tuna Salad Sandwich*  
*Tavern Mac n Cheese*

*Choice of dessert*  
*Cheesecake*  
*Godiva cake*

*Corporate Breakfast/ Corporate Lunch*

*\$35.00 per person*

*Plated Breakfast to include:*  
*Pancakes, Scrambled eggs, bacon or sausage*  
*Sliced seasonal fresh fruit*  
*Orange, Grapefruit, and Tomato juices*  
*Coffee, regular and decaf, tea or soda*

*Lunch to include three choices from the following:*

*Flat Iron Steak & fries*  
*Cedar planked salmon*  
*Prime rib French dip*  
*Chicken Pot Pie*  
*Alsatian chicken salad*  
*Cheeseburger*

*Choice of dessert:*  
*Cheesecake*  
*Godiva Cake*  
*Berry Crisp a la Mode*

# Lexington Room

25-50 people

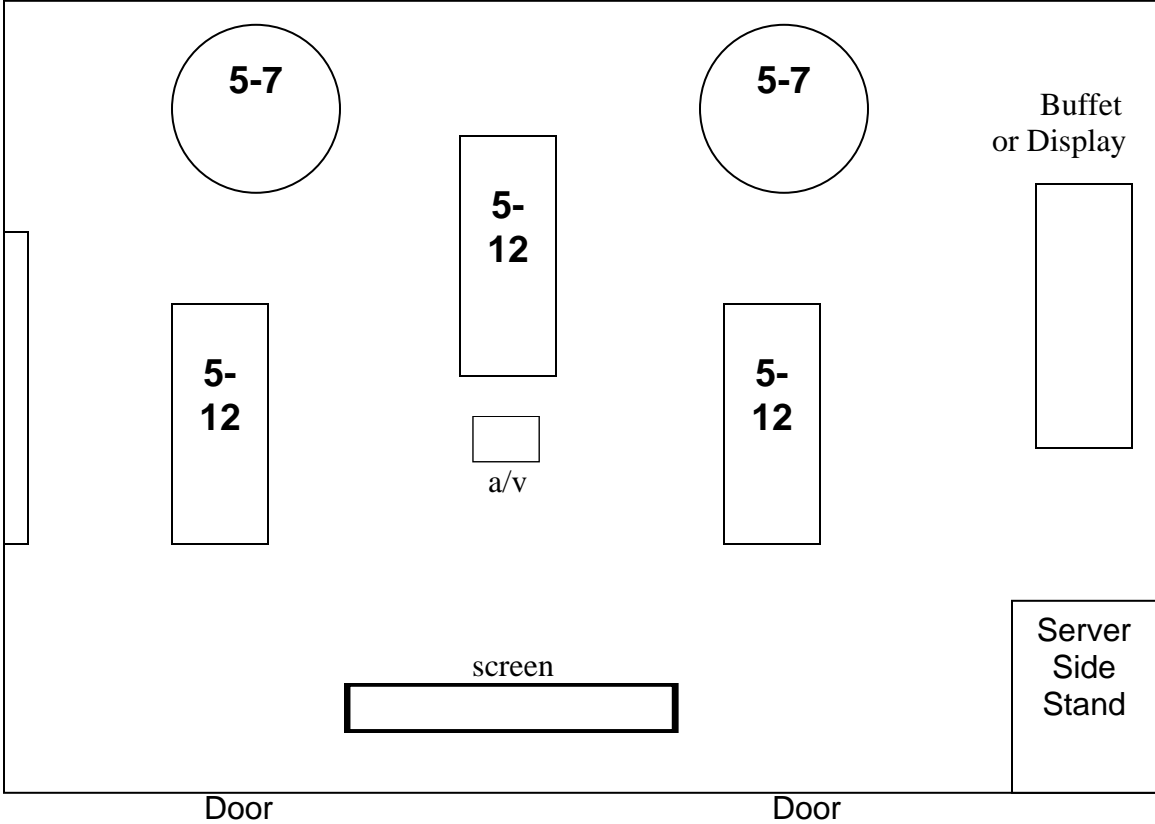

**Lexington Room**  
**25-40 people**  
**U Shaped**

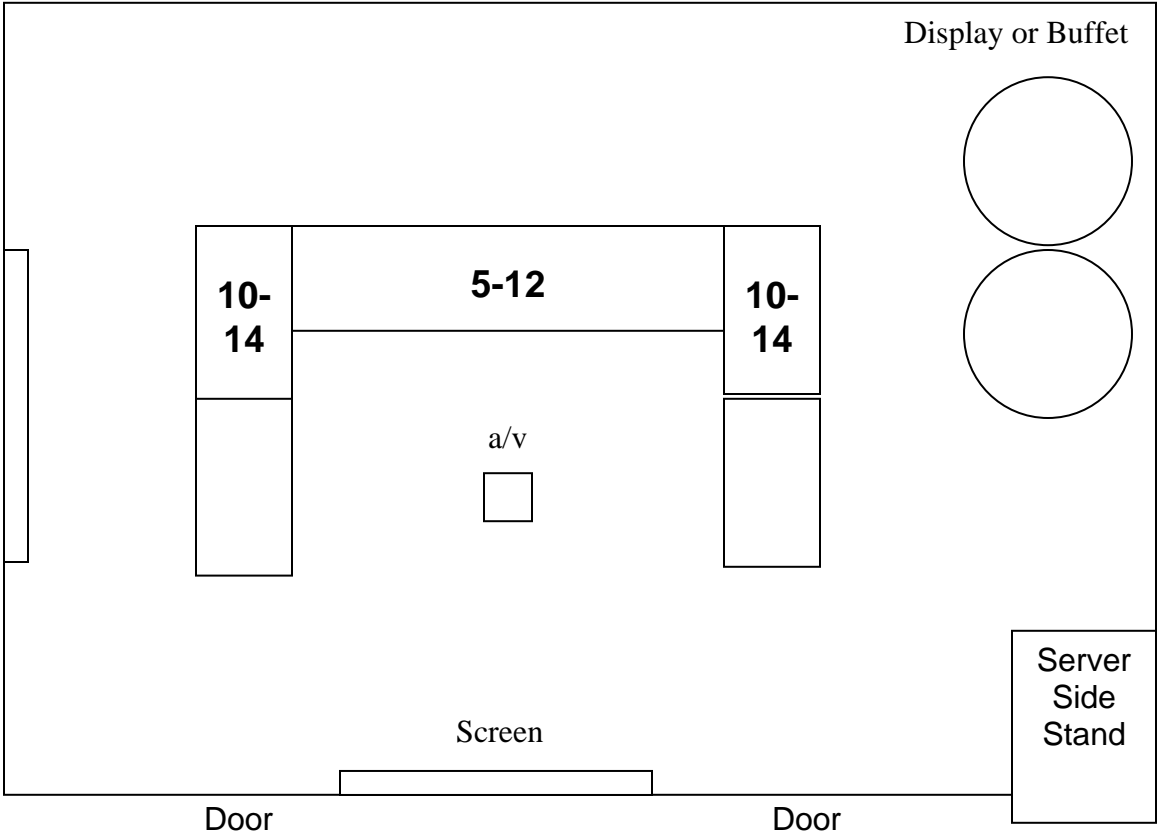

**Lexington Crown Room**  
**12-25 people**  
**Block Table**

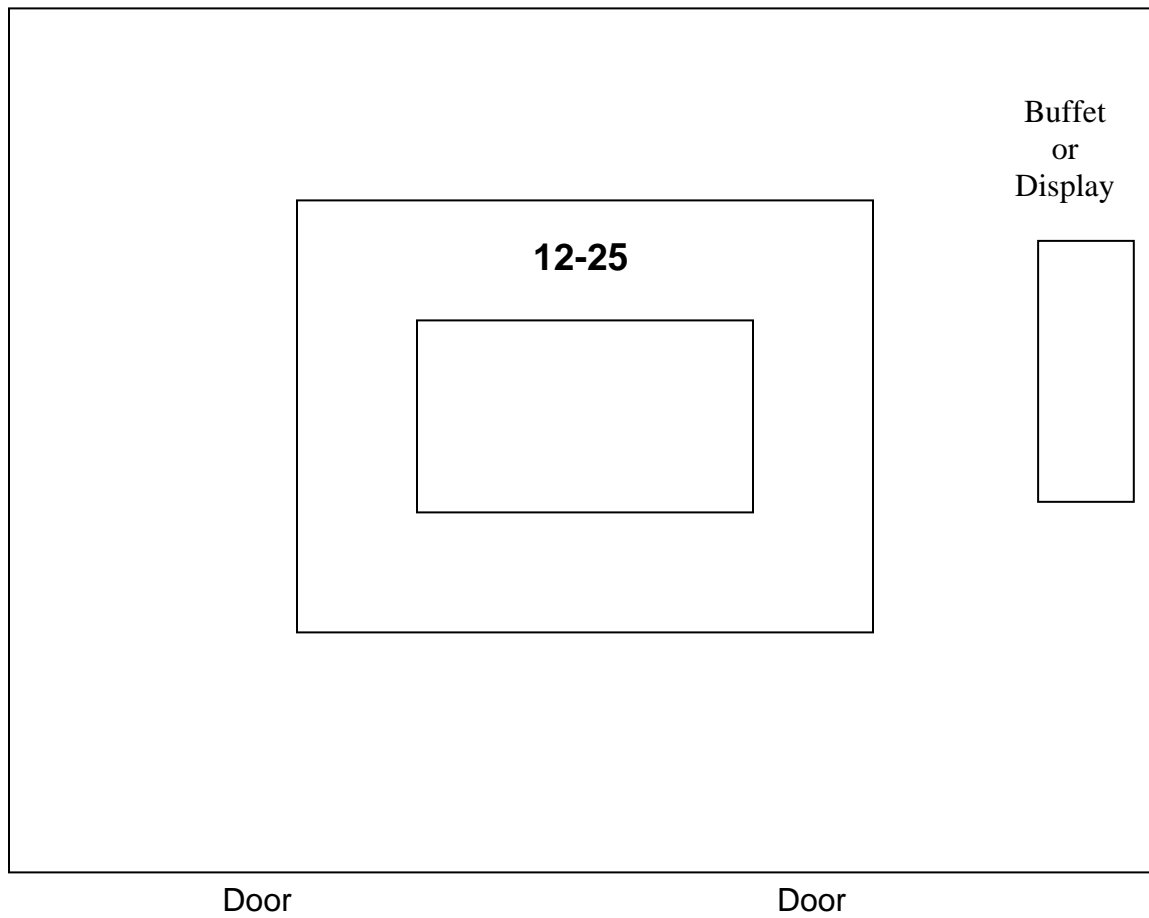

**Triple Crown Room**  
**14-25 people**  
**U-shape table**

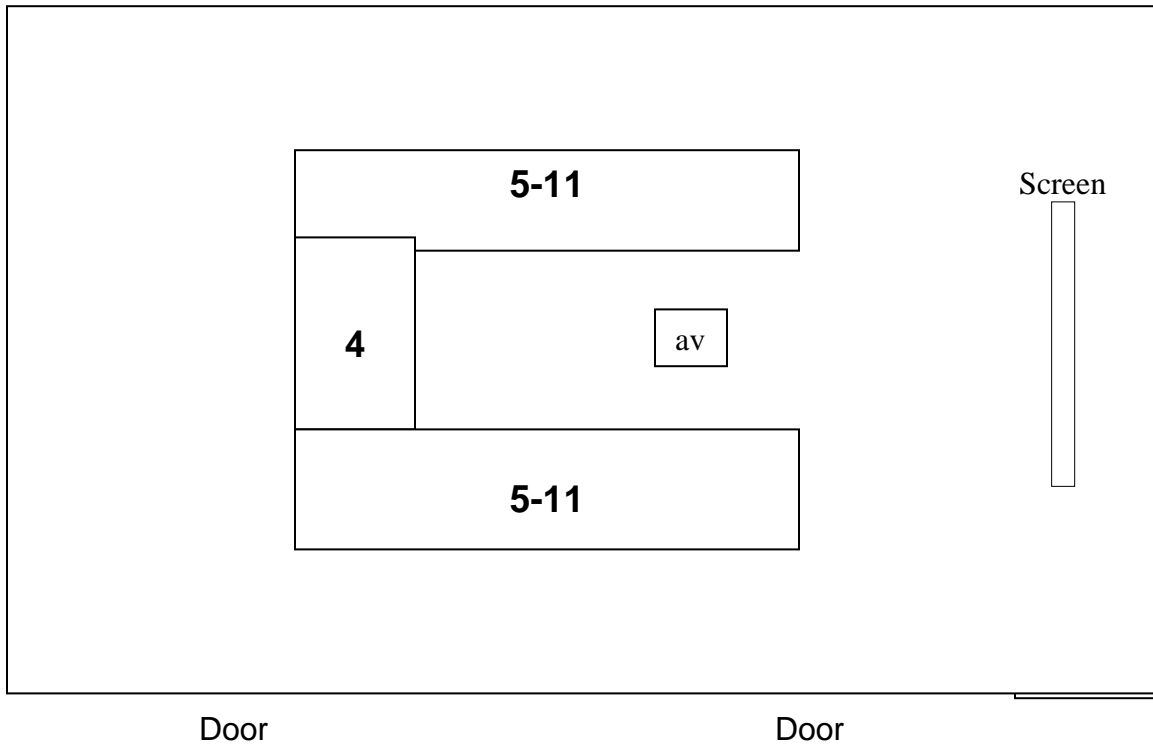

**Triple Crown Room**  
**8-20 people**  
**Block Table**

